



# Connect.pjm.com Roadmap

February 21, 2020

Product - Action Required	Dates	Who May Be Affected
<p><b>Connect.pjm.com integration with PJM's Single Sign On (SSO)</b> – Users will be prompted to log in through SSO instead of a browser prompt.</p>	<p><b>April 27, 2020</b></p>	<p>Connect.pjm.com users</p>





**Legend**

- Start Date
- ◆ End Date



Currently, connect.pjm.com prompts users for their accounts via the web browser; must use the following format: DMZ\username

After integration, users will be directed to PJM's Single Sign-On application.

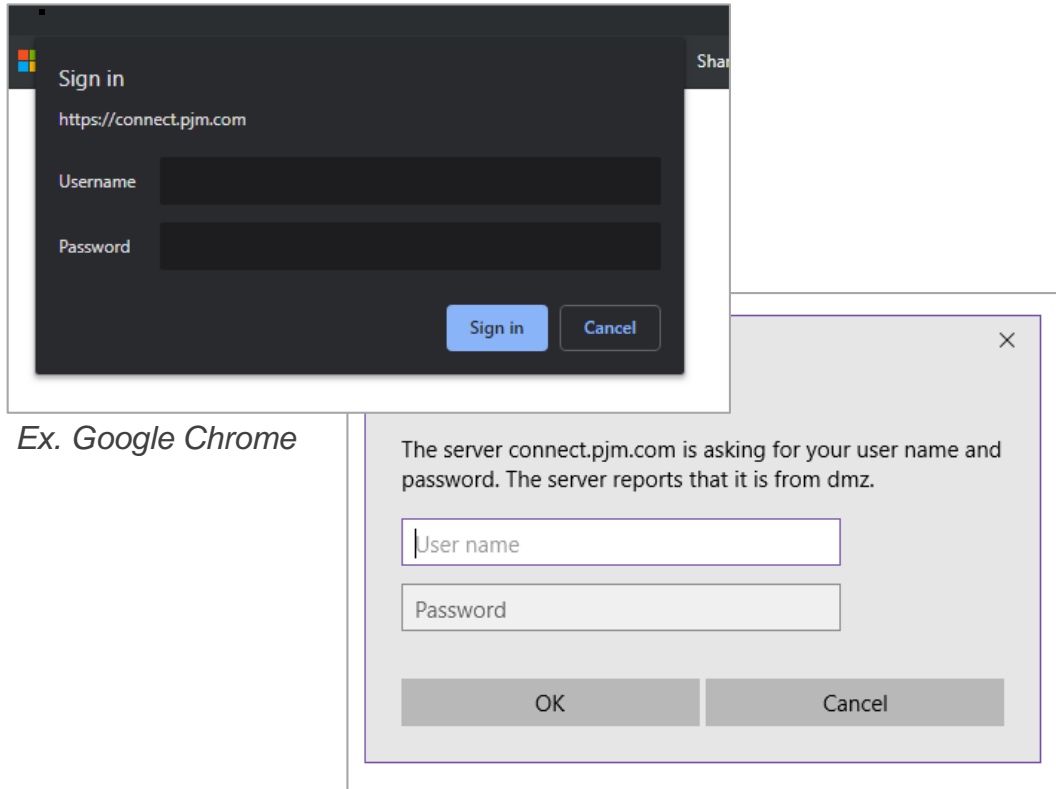

Ex. Google Chrome

Ex. Windows Internet Explorer



- January 22
  - During critical maintenance of external load balancers, internal and external connection to connect.pjm.com was lost
- February 7
  - SharePoint Support scheduled a test failover with the Networks team, identified half of the front end servers did not have the proper firewall settings
- Remediation and next steps
  - Firewall settings have been updated
  - A second failover test to be scheduled and communicated

Report issues or submit questions to:

- PJM's [Member Relations](#) or call 610-666-8980
- [SharePointConnectAdmins@pjm.com](mailto:SharePointConnectAdmins@pjm.com)
- Your site's PJM employee owner

Tech Change Forum

- [Educational recording](#)



# Product Details

Connect.pjm.com, PJM's external SharePoint site, allows PJM personnel and external stakeholders to collaborate and share data.

## Key Product Features

- Enables users to create robust, individualized sites to organize their projects, initiatives and tasks specific to their needs
- Using SharePoint apps, users can organize document submissions, data sets and calendars all in one site