



Connect.pjm.com Roadmap

As of March 18, 2020

- Impact Details slide
 - Changed implementation date from April 27 to April 26 and added the implementation time

Product - Action Required	Dates	Who May Be Affected
Implementation: Connect.pjm.com integration with PJM's Single Sign On (SSO)	April 26 5:00 p.m.	Connect.pjm.com users





Legend

- Start Date
- ◆ End Date



Currently, connect.pjm.com prompts users for their accounts via the web browser; must use the following format: DMZ\username

After integration, users will be directed to PJM's Single Sign-On application

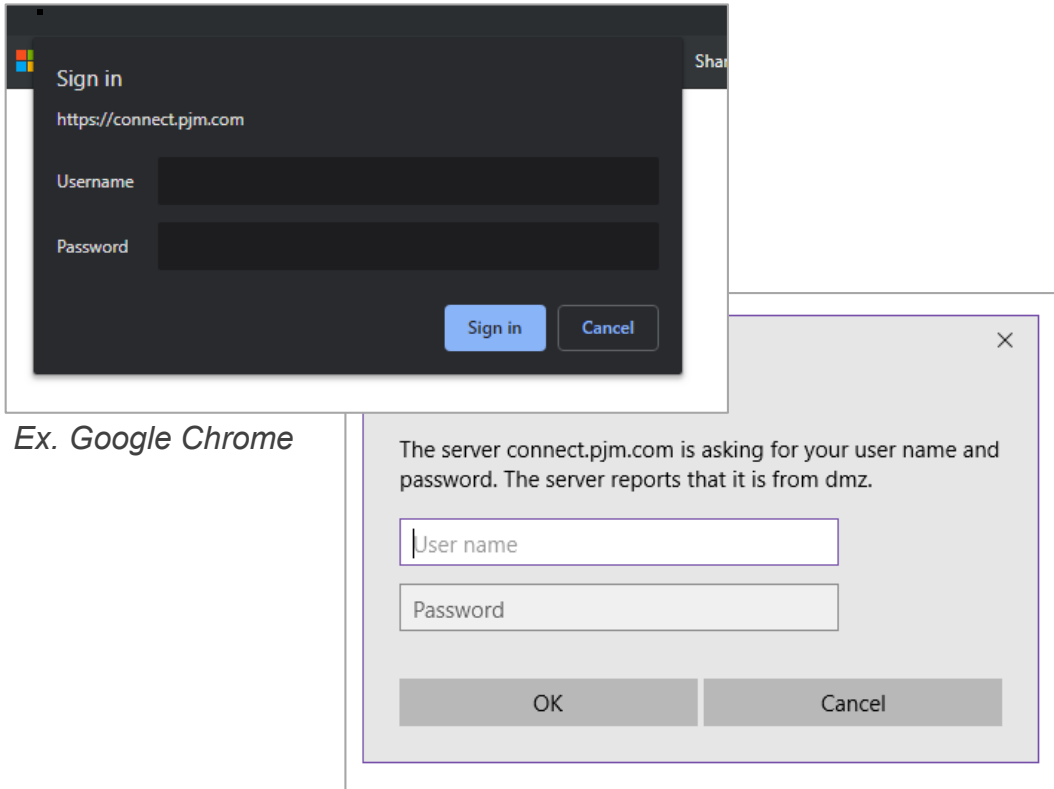

Ex. Google Chrome

Ex. Windows Internet Explorer



Report issues or submit questions to:

- PJM's [Member Relations](#) or call 610-666-8980
- SharePointConnectAdmins@pjm.com
- Your site's PJM employee owner

Tech Change Forum

- [Educational recording](#)

Product Details

Connect.pjm.com, PJM's external SharePoint site, allows PJM personnel and external stakeholders to collaborate and share data.

Key Product Features

- Enables users to create robust, individualized sites to organize their projects, initiatives and tasks specific to their needs
- Using SharePoint apps, users can organize document submissions, data sets and calendars all in one site